

PLAN VIEW

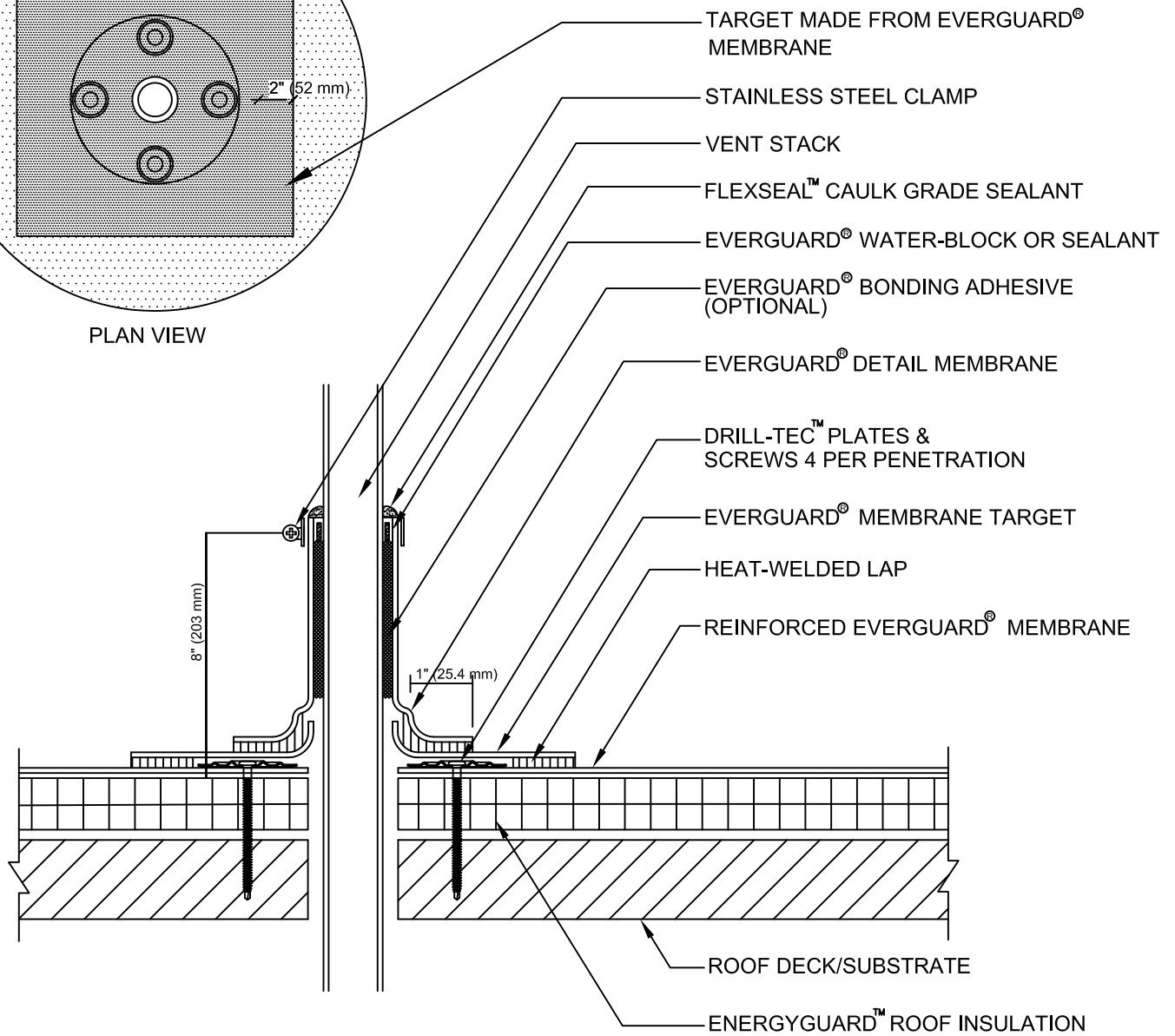

NOTE:

1. FOR INSULATION THICKNESS GREATER THAN 8" (203 mm), A HARD BOARD IS REQUIRED ON MECHANICAL SYSTEMS ONLY.
2. APPLY HEAT TO UNREINFORCED DETAIL MEMBRANE AND FORM BY HAND PRIOR TO HOT AIR WELDING.
3. APPLY EVERGUARD® TPO CUT EDGE SEALANT TO ALL CUT REINFORCED TPO EDGES (REFER TO EVERGUARD® DETAIL 115).



EverGuard
SINGLE-PLY ROOFING SYSTEMS
ROOF PENETRATION
SERIES

DRAWING #
507

**FIELD-WRAPPED PENETRATION
FLASHING DETAIL**

THIS DETAIL APPLIES TO:

ALL SYSTEMS

www.gaf.com
1 Campus Drive,
Parsippany, NJ 07054

SCALE
N.T.S.

REVISION DATE
6-21-16